

CURRENT TRANSFORMERS

CTA4 SERIES

Enclosed Self-Powered Split Core 100, 200, and 400 Amp Revenue Grade Current Transformers with 333 mV Output

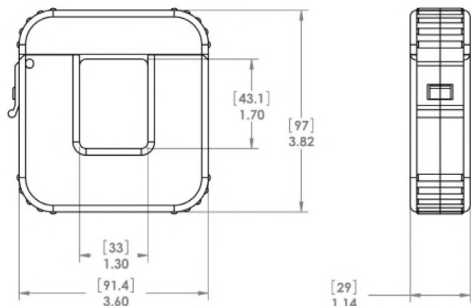

SPECIFICATIONS

Environment	Indoor Use Only 5 to 176° F (-15 to 80°C) 90% relative humidity
Wires	6', 18 AWG 600V Rated
Primary Input (A)	Arrow points toward Load
Secondary Output (V)	0.5% (typical)
Accuracy	10%-120%
Linearity	White-Hi, Black-Low
Polarity	40-400 Hz
Frequency Range	600 Vac
Max Sense Voltage	ETL Listed, CE, RoHS
Approvals	ETL Listed, CE, RoHS

SELECTION GUIDE

Model #	Primary Input (A)	Secondary Output (V)	Ratio	Accuracy (%)
CT-100A4-333	100	0.333	100A/0.333V	0.5
CT-200A4-333	200	0.333	200A/0.333V	0.5
CT-400A4-333	400	0.333	400A/0.333V	0.5