

## CURRENT TRANSFORMER

### CT-100A2-333

Enclosed Self-Powered Split Core 100 Amp Current Transformer with 333 mV Output

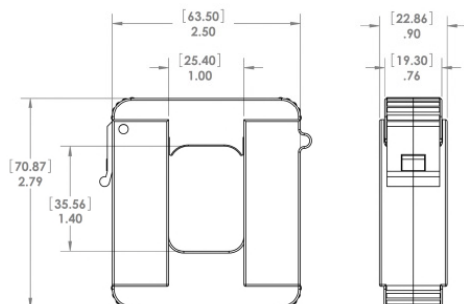

## SPECIFICATIONS

Environment	Indoor Use Only 5 to 176° F (-15 to 80°C) 90% relative humidity
Wires	6', 18 AWG 600V Rated
Primary Input (A)	100A max. AC 50/60 Hz
Secondary Output (V)	0.333 Vac
Accuracy	0.75% (typical)
Linearity	10%-120%
Polarity	White-Hi, Black-Low
Frequency Range	40-400 Hz
Max Sense Voltage	600 Vac
Approvals	ETL Listed, CE, RoHS
Ratio	100A/0.333V Alternate ratios available for large orders